

**URBAN
RANGE**

CITYPROTECT 4X URBAN CCTV POLES

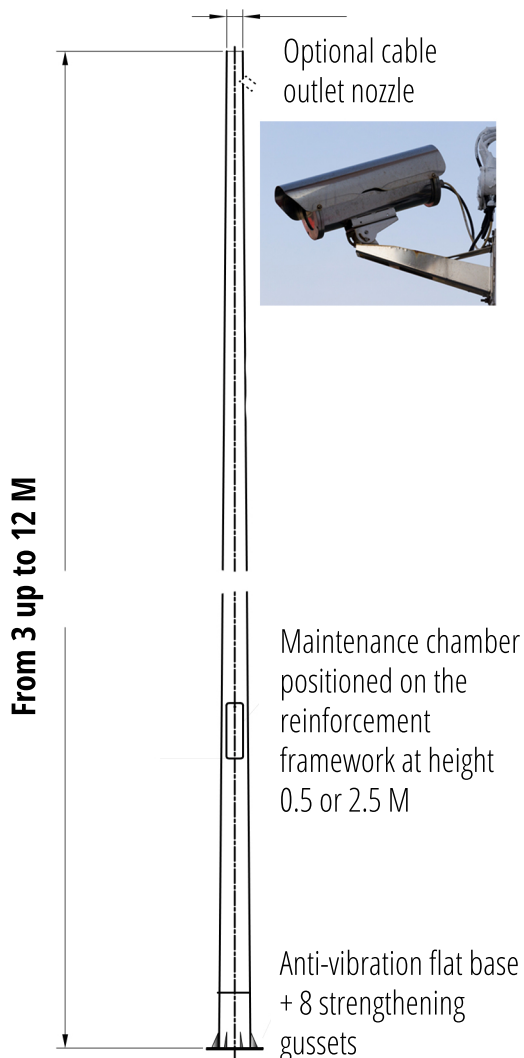

Top \varnothing 89 / \varnothing 115 mm



Urban CCTV mastCylindroid-conical for the deployment of cameras and/or Wi-Fi antennasin compliance with NF EN 60068.2-6 (cameras vibratory constraints)

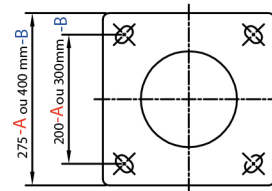

Anti-climbing collar



Anti-ram hoop



OPTIONS

Options upon request